



LIST OF ROOMS AT ALLERWATER HALL

[Allerwater Hall](#) is an impressive and stylish house, originally built in 1911, and recently modernised to 21st century standards, but retaining all the grace and elegance of the Edwardian period. With 15 bedrooms and 14 bathrooms this superb property can sleep up to 30 people.

Here's a list of all main rooms:

- **The Big Room:** a big impressive room in which to gather, socialise and celebrate. Think comfy seating, antique rugs, oak floors a large marble fireplace and even a piano!
- **Dining Room:** with plenty of space to seat 30 guests and incredible views of Dunkery Beacon (the highest point on Exmoor)
- **Games Room:** A haven for kids, this fun space has table football, a pool table and a big TV.
- **Kitchen and breakfast room:** fully equipped for catering for larger numbers with 3 ovens and 6-burner induction range, American style fridge-freezer, a separate drinks fridge, and two dishwashers.
- **Second Kitchen:** perfect for preparation. Here you'll find a further two ovens and 4-burner ceramic hob
- Lounge
- First floor gaming room
- Second floor kitchen

BEDROOMS – sleeps 30 in 15 bedrooms

● indicates a choice of bed configuration

Bedroom	Beds	Sleeps	Features
A - Ash Cove	Super king, can be divided into two single beds ●	2	En-suite disabled wet room. Level access for disabled guests
B - Badgworthy Water	Twin	2	En-suite. Level access
C - Chetsford Water	Super king, can be divided into two single beds ●	2	Level ground floor access
D - Danes Brook	King size sleigh bed	2	Interconnecting door to bedroom E. Shower room just next door.
E - Embercombe Water	King size cast iron bed	2	Interconnecting door to bedroom D. Bathroom with a beautiful roll top bath with overhead shower, just across the hall.
F - Farley Water	King size cast iron bed	2	Interconnecting door to bedroom G
G - Greenaleigh Sands	King	2	Interconnecting door to bedroom F
H - Heddon River	King	2	Master suite with very large en-suite bathroom with walk-in shower and a double ended slipper bath
I - Ivystone	Twin	2	Bathroom just across the hall



J - Jennifried's Cove	Super king, can be divided into two single beds ●	2	Bathroom right next door
K - Kinsford Water	Super king, can be divided into two single beds ●	2	Bathroom just down the hall
L - Long Pool	Super king, can be divided into two single beds ●	2	En suite shower room
M - Martinhoe	Super king, can be divided into two single beds ●	2	
N - Nutscale Water	King	2	Shared shower room and kitchen area with bedroom O
O - Oare Water	Super king, can be divided into two single beds ●	2	Shared shower room and kitchen area with bedroom N
Total		30	

Overall capacity:

- If each guest wants a private bedroom, the total capacity is 15.
- If each guest would like their own bed, the total capacity is 25.



FLOOR PLANS



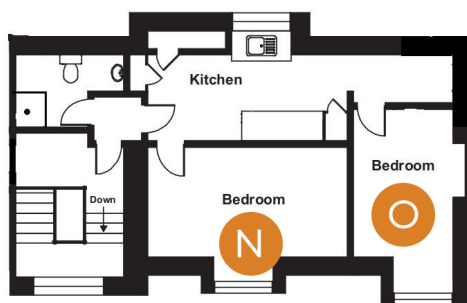
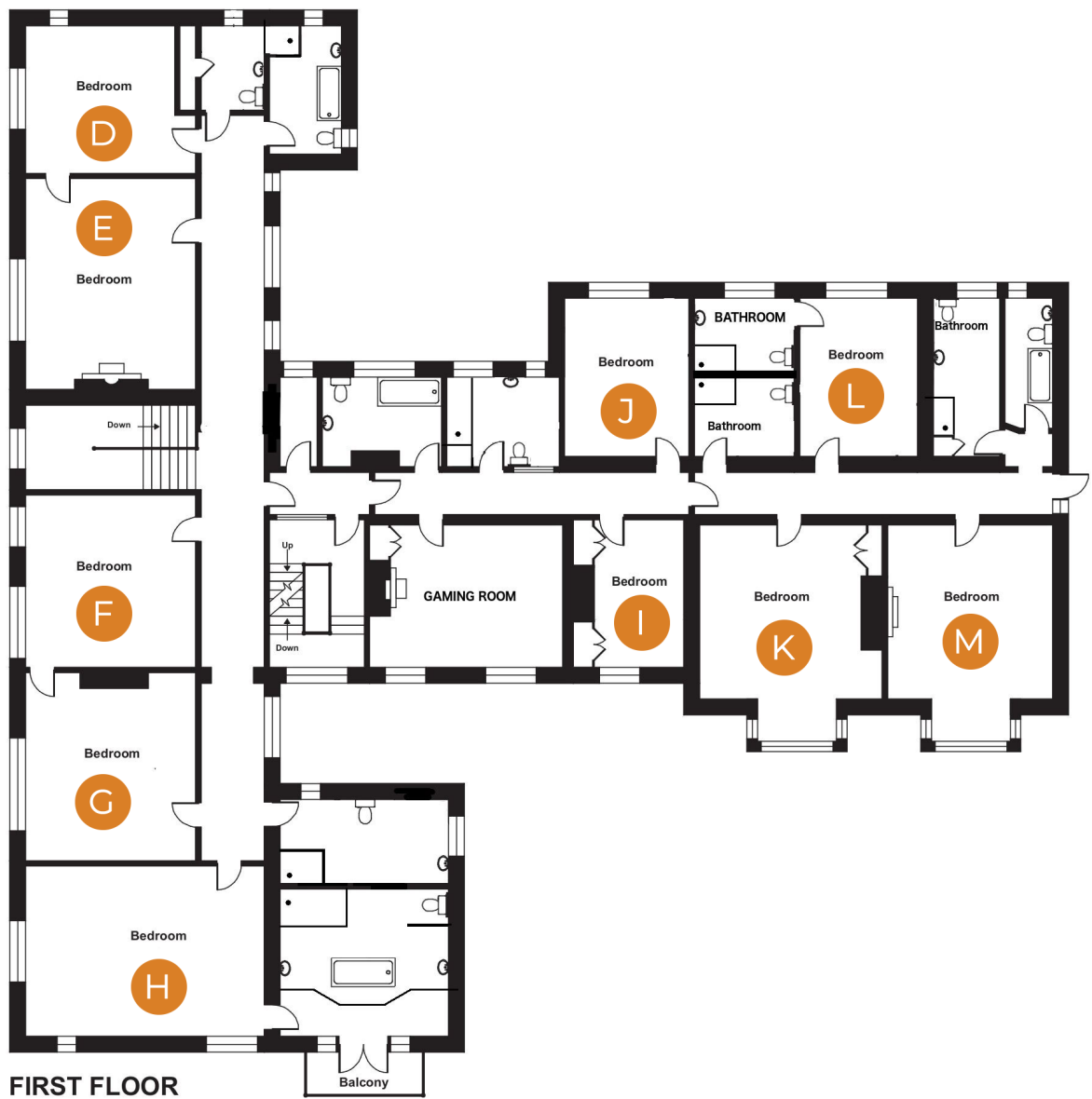

BIG HOUSE EXPERIENCE